

FL-15F-1

General Purpose Relay

 _{US} E173485
32×27.4×28.1



- QC&PC terminals
- High dielectric strength 3,000VAC
- Optional flanged case for panel mounting
- Class B/F available
- Conform to RoHS,ELV directive

CONTACT DATA

Contact Form	1H/1D/1Z
Contact Material	Silver Alloy
Load	Resistive load(COS Φ=1)
Contact Ratings	1H: 25A(30A) 240VAC/20A 28VDC 1D: 15A 240VAC/10A 28VDC 1Z: 20A/10A 240VAC/28VDC
Minimum load	500mA 5VDC
Max Switching Voltage	250VAC/30VDC
Max Switching Current	30A
Max Switching Power	7200VA/560W
Contact Resistance	100mΩ Max at 6VDC 1A
Electrical	100,000 Operations(at30Operations/minute)
Mechanical	10,000,000 Operations(at300Operations/minute)

CHARACTERISTICS DATA

Insulation Resistance	100MΩ Min at 500VDC
Between Open Contacts	1500VAC(for one minute)
Between Contacts and Coil	1500VAC/2500VAC(for one minute)
Operate Time	15ms
Release Time	10ms
Shock Resistance	-40℃to+70℃ (Class F:85℃)
	Operating Extremes: 10G
Vibration Resistance	Damage Limits: 100G
Max. switching frequency	10-55Hz, 1.5mm
Humidity	Mechanical:18,000operations/hr Electrical:1,800operations/hr
Weight	40-85%
Shock Resistance	Approx 36g

COIL DATA

at 20℃

Coil Power 0.93W

Nominal Voltage (VDC)	Rated Current (mA)	Max Operate Voltage (VDC)	Min Release Voltage (VDC)	Coil Resistance (Ω ±10%)
5	186	3.75	0.5	27
6	155	4.5	0.6	39
9	103	6.75	0.9	87
12	77.5	9	1.2	155
24	39	18	2.4	620
48	19	36	4.8	2480

APPROVED STANDARDS

UL & cUL	NO: 25A 240VAC 25A 28VDC NC: 15A 240VAC 15A 28VDC
----------	--

ORDERING CODE

$\underline{\text{FL-15F-1}}-\underline{\text{S}}-\underline{\text{Z}} \quad (\underline{\text{TBF-1}}) \quad \underline{\text{T}} \quad / \quad \underline{12\text{VDC}}$					
1	2	3	4	5	6
<p>1. Relay Model</p> <p>2. Sealed K: Open Type</p> <p>3. Contact Form H: Form A, Z: Form C, D: Form B</p> <p>4. Insulated Level TBF-1: Class F Nil: Standard</p> <p>5. T: Between Contacts and Coil 2500VAC Nil: Between Contacts and Coil 1500VAC</p> <p>6. Coil Nominal Voltage 5,6,9,12,24,48VDC</p>					



OUTLINE DIMENSIONS, WIRING DIAGRAM AND LAYOUT

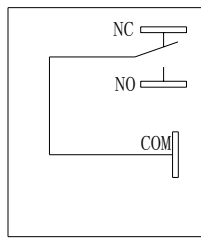
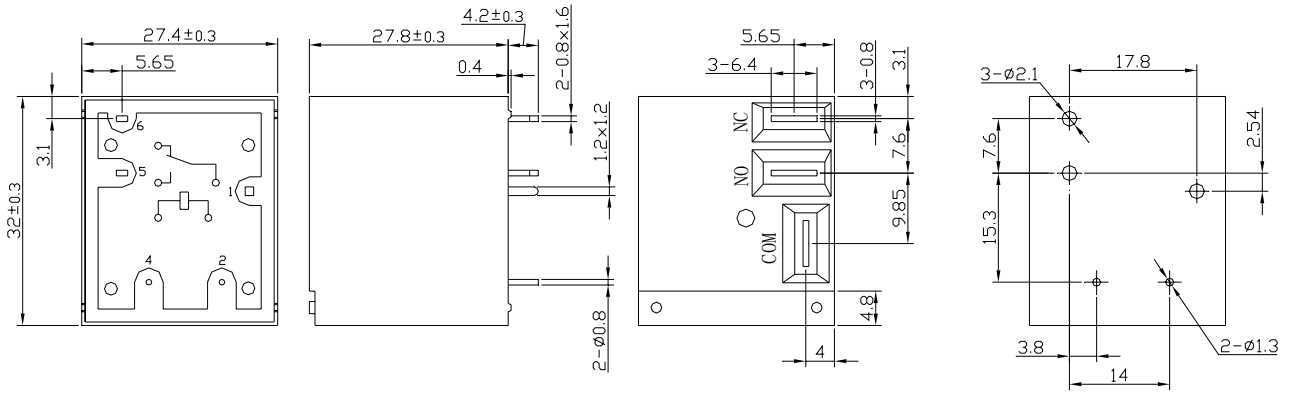

Layout (Top view)

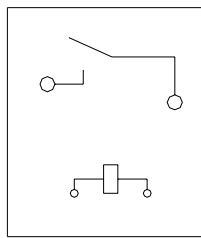

1A

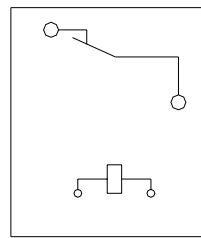

1B

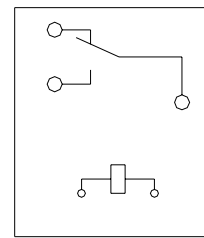

1C

Layout (Bottom view)

ENGINEERING DATA

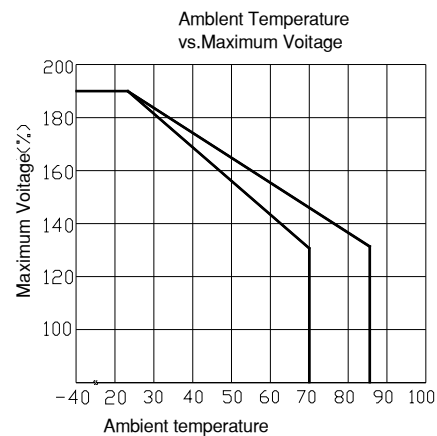
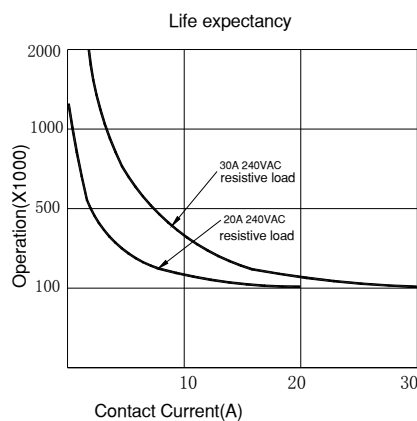
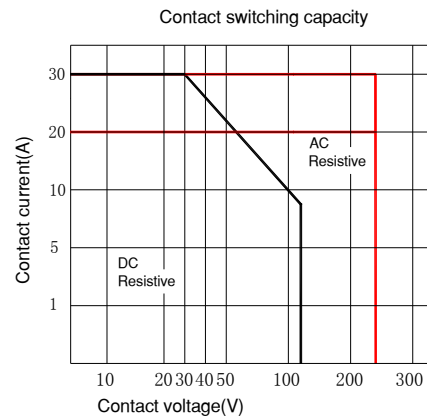
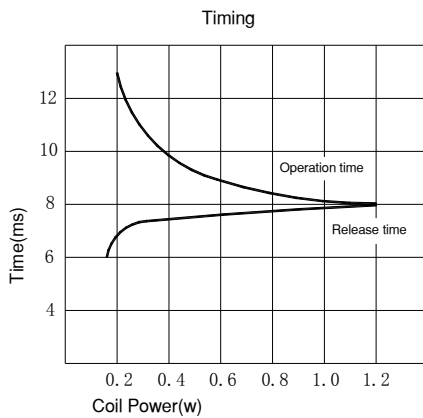

FLOURISHING RELAY

The specifications are for the customer's reference and are subject to change without notice.